



Welcome to another edition of the Facilities Services newsletter. The upcoming construction season promises to be a busy one with projects that are in design, about to start construction, currently underway, or in the completion stages. In this edition, you will find an update on the current projects, upcoming events, and other information.

INNOVATIVE TEACHING AND TECHNOLOGY CENTER (EAST GYM RENOVATION)

Construction continues on the East Gym Renovation. Progress is being made on the interior and exterior of the building. The work includes removing the pool, adding a new west entrance, a new elevator and stair tower serving both buildings, and construction of a new floor within the existing top floor gymnasium volume. The end result will produce state-of-the-art classroom, teaching, and educational support spaces while preserving the historically significant architectural design and detailing. The projected completion date is December 2005.



MCLEOD CENTER

Construction on the McLeod Center began in November 2004. The McLeod Center will be a 6,100 seat multi-purpose facility which will provide an improved venue for the University's men's and women's basketball, volleyball, and wrestling teams while also allowing for performance events and enhanced interactions with the community. Currently, site work, utilities, and foundations are being constructed. The structure should get out of the ground this summer with the projected completion date of October 2006. See our progress:

<http://www.vpaf.uni.edu/facplan/Content/McLeod/Current/webcam-live.asp>

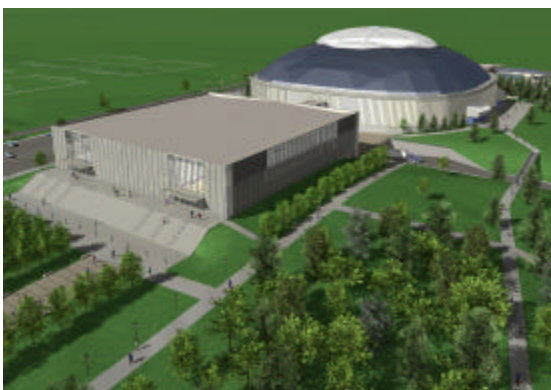

BUSINESS AND COMMUNITY SERVICES BUILDING

A new Business and Community Services building will be constructed to provide training rooms, a computer lab, multi-media conference center, experiential learning classrooms, entrepreneurial suites, virtual incubator facilities, and required office space. The facility will be constructed to more adequately serve the programs' needs. Competitive bids are scheduled to be received on May 26th. Construction is planned to start in early June 2005 and will be completed Fall 2006.

CAMPUS SUPPLY

Campus Supply is UNI's Vendor of First Choice for office supplies. By working through a contract with Office Depot, Campus Supply is able to keep prices at a minimum. With price matching and front door delivery they are able to serve all your needs. Also, when buying any product from Campus Supply, the purchaser is given the opportunity to be put into a drawing to receive 8,000 points toward any Hewlett-Packard product.

CHARGE UP TO RECYCLING

Facilities Services is highlighting their newest effort in recycling. The recycling is for all types of rechargeable batteries, except alkaline batteries. The batteries must weigh less than two pounds. Each battery to be recycled must be placed in an individual plastic bag. The bags and reminders are located at the drop off stations. Currently, there are two locations for drop off- Campus Supply (Physical Plant 33) and the Electrical Shop. This is an opportunity to keep our hazardous waste bill down, and with everyone's help this is can be another win for the University.

FIRE EXTINGUISHER TRAINING

Facilities Services will be holding a fire extinguisher training day August 9th, 2005. The session will be one half hour long and will give hands on experience in fire extinguishing. The training will be held in the Campbell parking lot and is \$10 per person. Contact Darrell Hansen at 3-2004 for registration or questions.

FUN FACTS

1. We use 10,272,600 feet of roll towels per year based on 15,000 faculty, staff, students, visitors. Each person uses 684.8 feet of towels per year.
 - o We spend approximately \$3.15 per year per set of hands.
2. We use 1,831,296 terry towels per year mostly used by food services and custodial staff for cleaning purposes.
3. We use 54,815,040 feet of toilet tissue per year based on 15,000 faculty, staff, students, and visitors. Each person uses 3,654.34 feet of toilet tissue per year per person.
 - o We spend approximately \$4.10 per year per person.

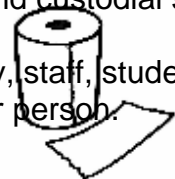

INSTITUTIONAL ROADS 2005

The scope of this project includes the realignment and reconstruction of Nebraska Street from the UNI-Dome north to 22nd Street. The project is currently under design with Ament, Inc. Bids are anticipated to be received in May 2005 followed by a construction period of June to September 2005. Access to the Wellness Center metered parking lot and the UNI-Dome north service entrance will be maintained throughout the construction period. This project will be completed this fall.

PARKING LOT MAINTENANCE

Work and estimates have been prepared for review on this project. Decision to proceed is pending. If the project is approved, a construction period will be expected through July and August.

SCIENCE BUILDINGS RENOVATION PHASE I

The Physics Building and Greenhouse will be completely renovated with new mechanical and electrical systems, exterior repairs, and interior improvements. We anticipate the project bidding in late 2005 or early 2006.

STEAM DISTRIBUTION SYSTEM REPLACEMENT

This project has been in progress for over three years but will finally come to an end this summer. The tie in of steam piping to several buildings, final backfilling, and restoration of the fenced in areas should be complete in May 2005.



STUDENT HEALTH CENTER

The Student Health Center project is rapidly coming to an end. The completed project will house an expanded Student Health Clinic as well as a relocated Counseling Center and Office of Disability Services. Expected occupancy date is July 2005.



WAYFINDING

Directional signage has been installed in six locations on campus to assist visitors and new students in finding their way around campus. Signs were also installed at building entrances to identify the building's name and street address. These signs are part of a larger program to make the campus more user-friendly. Additional directional signs are expected to be installed in the next couple of years.

WEBSITE

The current website is in the process of being redesigned. To access the Facilities Services Web site in the mean time, please visit: <http://www.vpaf.uni.edu/fs/>

MAJOR CONSTRUCTION MAP

A map of major construction activity can be viewed at the end of this newsletter. A specific major pedestrian disruption will be around the East Gym. The building perimeter will be surrounded with fencing identifying the construction limits. The Contractor entrance to the site is off of 23rd Street through the western portion of the Bartlett A parking lot. Throughout the duration of the project, a portion of the sidewalk within the construction limits between Bartlett Hall and Physics will be closed to pedestrian traffic at a location near the northwest corner of Physics. Pedestrian access to the Physics west door (by Elevator) and the east door of the East Bartlett shall be maintained for use.

UNIVERSITY OF NORTHERN IOWA
CEDAR FALLS, IOWA

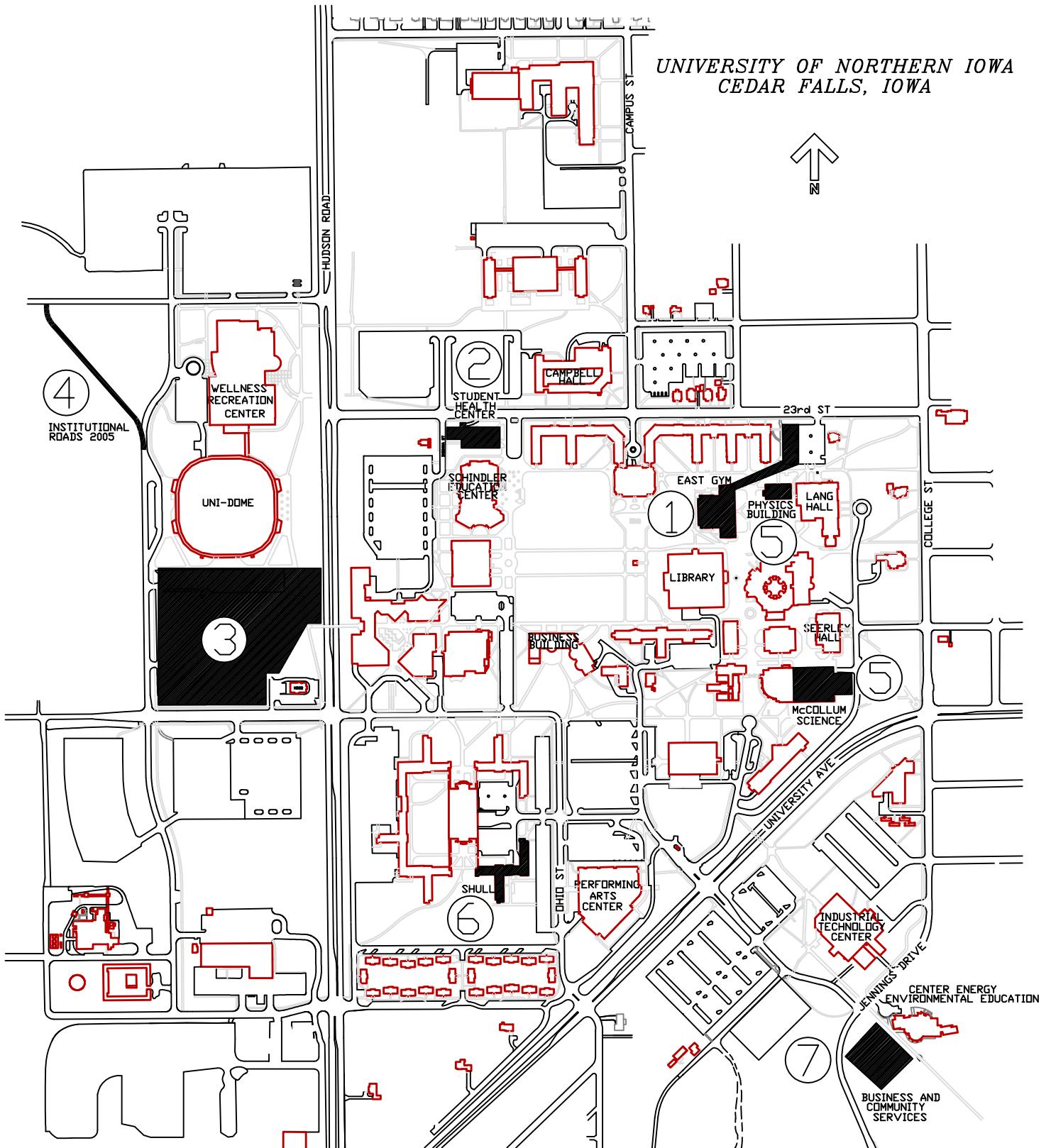

- ① INNOVATIVE TEACHING TECHNOLOGY CENTER (EAST GYM RENOVATION)
- ② STUDENT HEALTH CENTER EXPANSION
- ③ McLEOD CENTER
- ④ INSTITUTIONAL ROADS 2005

- ⑤ SCIENCE BUILDING RENOVATION
- ⑥ SHULL HALL UPPERCLASS RESIDENCE
- ⑦ BUSINESS AND COMMUNITY SERVICES